

Fishbourne Road West, Chichester
Approximate Gross Internal Area
Outbuilding = 846 Sq Ft/79 Sq M

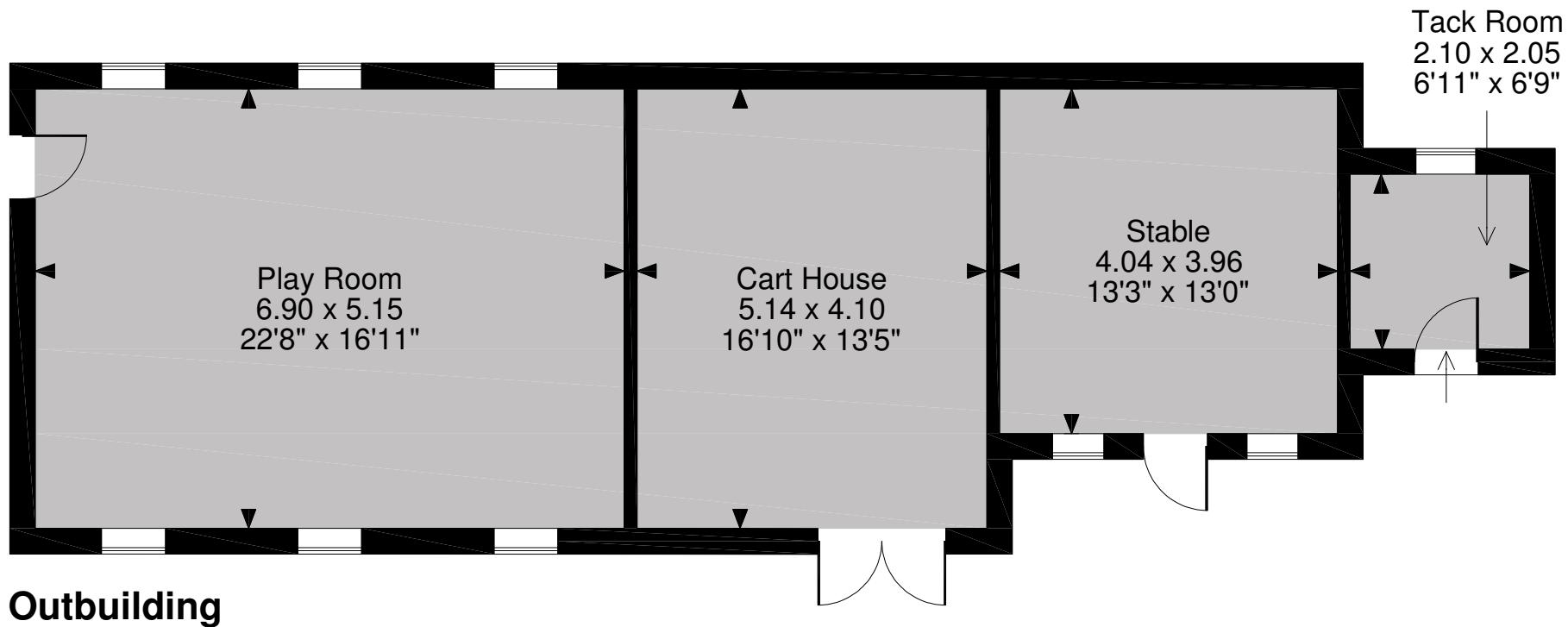

FOR ILLUSTRATIVE PURPOSES ONLY - NOT TO SCALE

The position & size of doors, windows, appliances and other features are approximate only.

© ehouse. Unauthorised reproduction prohibited. Drawing ref. dig/8437866/DWL