

# Oakely Close, Isleworth, TW7

Approximate Gross Internal Area  
104.2 sq m / 1122 sq ft

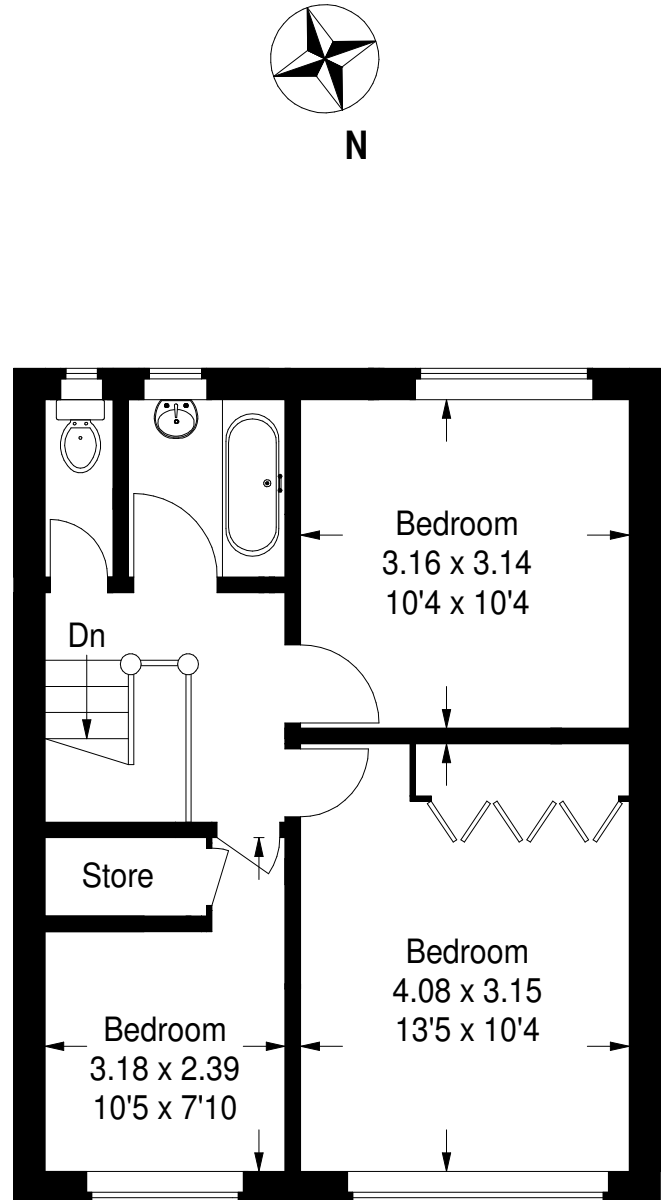
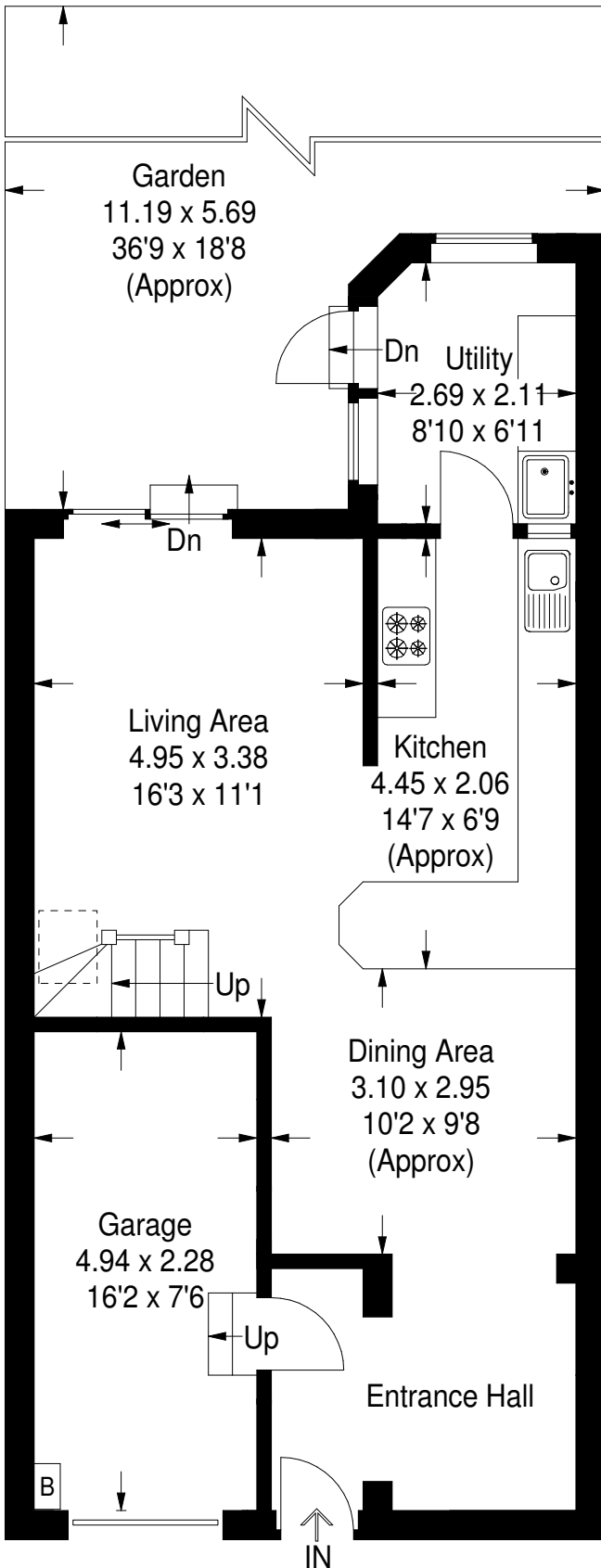

 = Reduced headroom below 1.5 m / 5'0

**Ground Floor**

**First Floor**

Illustration for identification purposes only, measurements are approximate, not to scale.

FloorplansUsketch.com © 2015 (ID139924)