



**Franciscan Way, Ipswich,
Suffolk, IP1 1NA
£70,000
Leasehold**

This second floor studio apartment situated in Ipswich town centre comes with electric heating and comprises open plan hall / kitchen / living / bedroom and shower room.

AGENTS NOTE:

The cladding is in the process of being replaced and the vendor has confirmed that payment has been made to the Management Company to cover the cost.

LEASE INFORMATION:

Ground rent - £100 per annum
Service charge - £2,000 per annum
Lease - 112 years remaining

The county town of Ipswich offers a range of local amenities including schools, university, shops, doctors, dental surgeries, hospital, two theatres, parks including the popular Orwell Country Park, recreational facilities, and mainline railway station providing direct links to London Liverpool Street Station. The town has also undergone an extensive rebuilding and a gentrification programme principally around the vibrant waterfront which now boasts some lovely bars and restaurants.



Ground Floor

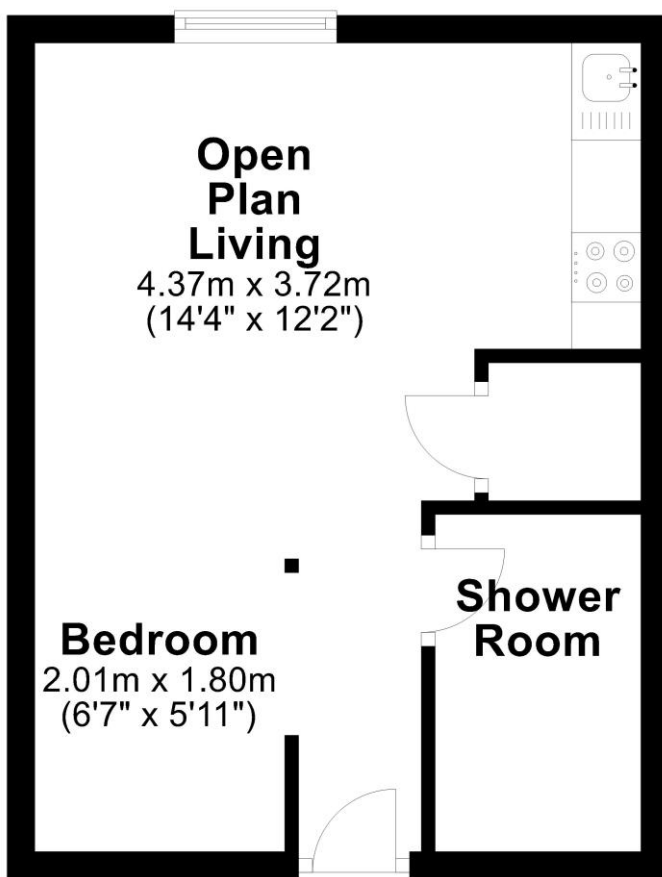

Energy Efficiency Rating		Current	Potential
Very energy efficient - lower running costs			
(92-100)	A		
(81-91)	B		
(69-80)	C		
(55-68)	D		
(39-54)	E		
(21-38)	F		
(1-20)	G		
Not energy efficient - higher running costs			
England & Wales		82	87
		EU Directive 2002/91/EC	

Environmental Impact (CO ₂) Rating		Current	Potential
Very environmentally friendly - lower CO ₂ emissions			
(92-100)	A		
(81-91)	B		
(69-80)	C		
(55-68)	D		
(39-54)	E		
(21-38)	F		
(1-20)	G		
Not environmentally friendly - higher CO ₂ emissions			
England & Wales			
		EU Directive 2002/91/EC	

Palmer and Partners would like to draw your attention to the following: I] these particulars do not constitute part of an offer or contract. II] these particulars and any pictures or plans represent the opinion of the author and are given in good faith for guidance only and must not be construed as statement or fact. III] nothing in these particulars shall be deemed a statement that the property is not in good condition or otherwise. We have not carried out a structural survey of the property and have not tested services, appliances and special fittings IV] measurements are generally taken by the use of a sonic measuring machine and will usually be the largest measurements of the room in question.