



High Street
Motherwell, ML1 5JU

move  on

High Street
Motherwell
ML1 5JU

Flat/Apartment

**1 Bedroom
1 Reception
1 Bathroom**



move on
www.moveonhomes.co.uk

01698 757 125

KEY FEATURES

- Well presented first floor flat
- Good room sizes with fresh neutral decor throughout
- Bright lounge with laminate flooring
- Lovely kitchen with oak coloured wall and floor units and breakfast bar area
- Modern bathroom suite with shower over the bath and a chrome towel rail
- Rear garden
- Close to local amenities
- Just a few moments' drive from the M8 motorway
- Handy for public transport links - close to bus stop and within walking distance to Carfin train station which has frequent services to Glasgow and Edinburgh
- COUNCIL TAX BAND: A - EPC RATING: C



move on

www.moveonhomes.co.uk





30

18

15

11

13

23

35

37

49

51

5

55

57

29

High St (B7066)

+ 145.1m

Shelter

85 01 05
50 to 58

2 to 12

Macinnes Mews

Community
Education

09

Surge

Caledonia Dr

High St (B7066)

High Street, Motherwell, ML1 5JU

Move On are delighted to present to the market this 1 bedroom, 1st floor flat in Newarthill - High Street.

This lovely flat has good room sizes and is in excellent condition throughout. The accommodation features: A bright lounge with fresh, neutral decor and laminate flooring; spacious kitchen with oak coloured wall and floor units and breakfast bar area; large double bedroom; and a modern bathroom suite with white sanitary-ware, shower over the bath and a chrome towel rail. There is gas central heating and double glazing.

Externally there is a garden to the rear, which is mostly paved and has clothes drying area.

High Street is located in the quiet village of Newarthill, just outside Motherwell. Newarthill has a range of local amenities including local shops, hairdressers, take-aways doctors, dentist, optician, public houses and mini supermarkets as well as a number of Primary Schools and Secondary Schools. Both Carfin and Cleland train stations are within easy reach, connecting Glasgow and Edinburgh. Nearby larger towns include Bellshill, Wishaw and Motherwell which have a larger selection of retail and leisure facilities including the Brandon Shopping Centre, Ravenscraig Sports complex, Aquatec and Strathclyde Country Park. For those commuting by car, both the M8 and M74 are within a few minutes' drive.

move on

ROOM MEASUREMENTS

Lounge: 4.51m (14' 10") x 3.70m (12' 2")

Kitchen: 3.70m (12' 2") x 3.20m (10' 6")

Bedroom 1: 4.50m (14' 9") x 3.80m (12' 6")

Bathroom: 3.80m (12' 6") x 2.00m (6' 7")

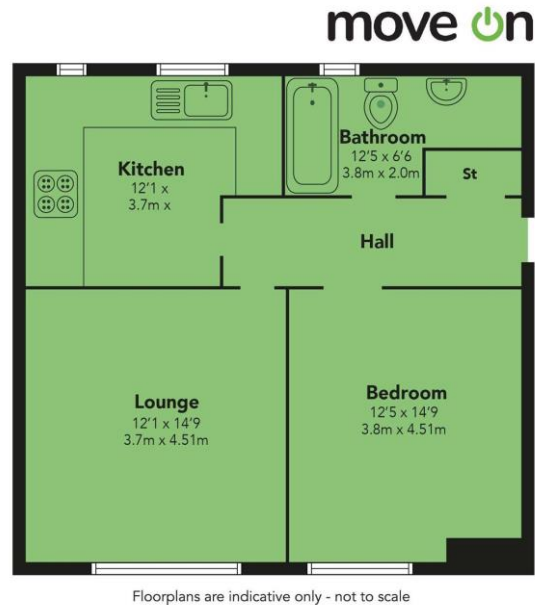

These particulars are intended to give a fair description of the property but their accuracy cannot be guaranteed, and they do not constitute an offer of contract. Intending purchasers must rely on their own inspection of the property. None of the appliances/services have been tested by ourselves. We recommend that purchasers arrange for a qualified person to check all appliances/services before legal commitment.

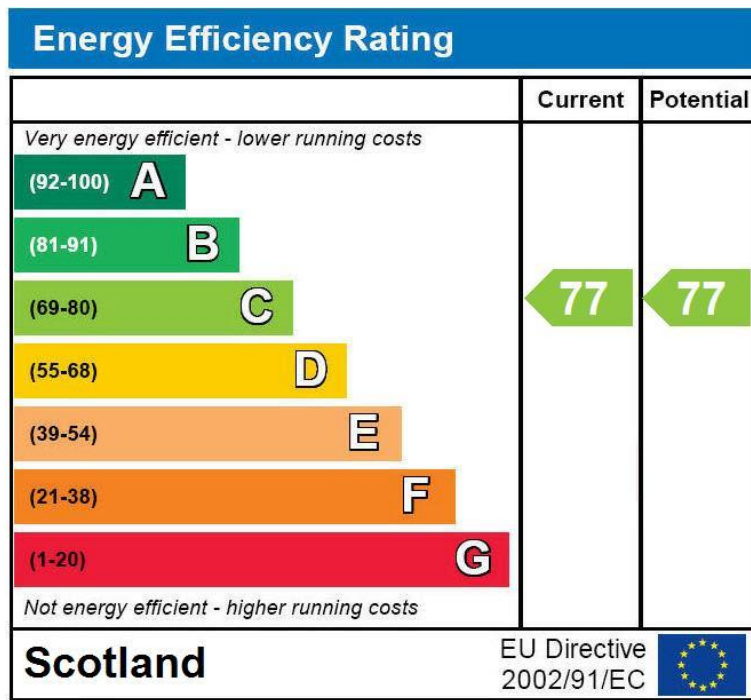

Energy Efficiency Rating

This graph shows the current efficiency of the property, taking into account both energy efficiency and fuel costs. The higher this rating, the lower your fuel bills are likely to be.

The current rating is **band C (77)**. The average rating for EPCs in Scotland is **band D (61)**.

The potential rating shows the effect of undertaking all of the improvement measures listed within the Energy Performance certificate recommendations report.

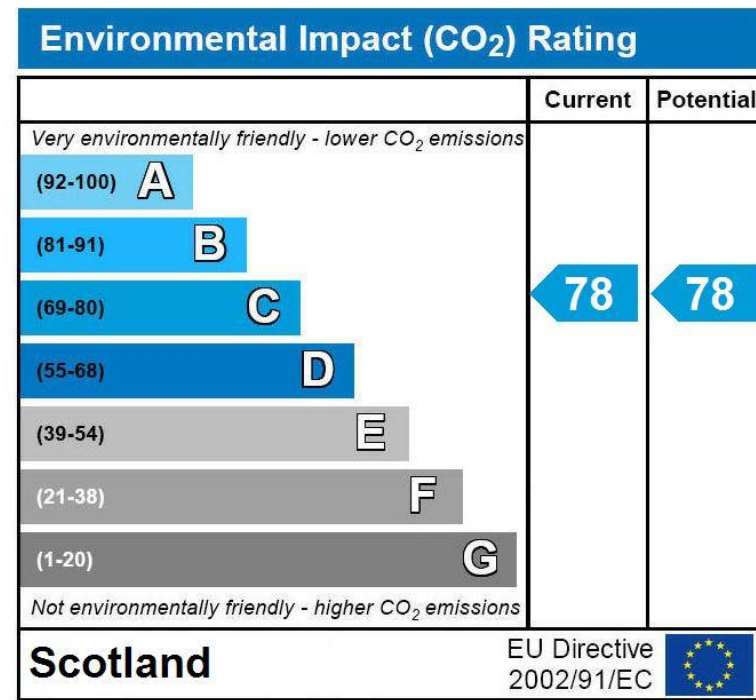

Environmental Impact (CO₂) Rating

This graph shows the effect of the home on the environment in terms of carbon dioxide (CO₂) emissions. The higher the rating, the less impact it has on the environment.

The current rating is **band C (78)**. The average rating for EPCs in Scotland is **band D (59)**.

The potential rating shows the effect of undertaking all of the improvement measures listed within the Energy Performance certificate recommendations report.

move n

166 Merry Street, Motherwell, ML1 1NA

EMAIL : info@moveonhomes.co.uk

WEB : www.moveonhomes.co.uk

01698 757 125

 facebook.com/moveonhomes