



Hayes

£550,000 Freehold

Space on the side

Karwood bring to the market this well presented three bedroom semi-detached property which offers space to the side to extend (subject to planning permission). Located in Hayes end with good access to local schools, shops and transport links. Having been looked after by its present owners and offering good sized accommodation this home would suit anybody looking for a home for their family. This home also includes fitted wardrobes to all bedrooms and off street parking to the front.

Features

- House
- Semi detached
- Three bedrooms
- Reception Area
- Dining Area
- Fitted Kitchen
- Off street parking
- Space to the side



Ground Floor

Approx. 41.0 sq. metres (441.3 sq. feet)

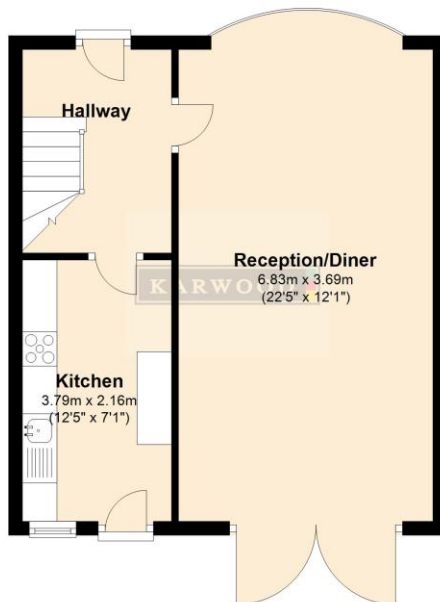

First Floor

Approx. 39.1 sq. metres (420.7 sq. feet)

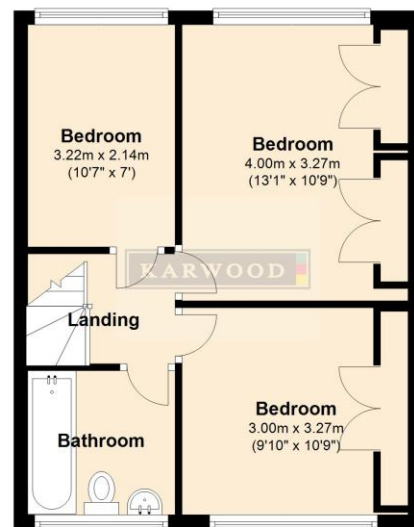

Total area: approx. 80.1 sq. metres (862.0 sq. feet)

Whilst every attempt has been made to ensure the accuracy of the floor plan contained here, measurements of doors, windows, rooms and other items are approximate and no responsibility is taken for any error, omission, or mis-statement. This plan is for illustrative purposes only and should be used as such by any prospective purchaser. The services, systems and appliances shown have not been tested and no guarantee as to their operability or efficiency can be given.

Plan produced using PlanUp.

Energy Efficiency Rating		
	Current	Potential
Very energy efficient - lower running costs		
(92-100) A		
(81-91) B		
(69-80) C		
(55-68) D		
(39-54) E		
(21-38) F		
(1-20) G		
Not energy efficient - higher running costs		
England & Wales	EU Directive 2002/91/EC	86

Environmental Impact (CO ₂) Rating		
	Current	Potential
Very environmentally friendly - lower CO ₂ emissions		
(92-100) A		
(81-91) B		
(69-80) C		
(55-68) D		
(39-54) E		
(21-38) F		
(1-20) G		
Not environmentally friendly - higher CO ₂ emissions		
England & Wales	EU Directive 2002/91/EC	

Location

