



Yeading

£339,950 Freehold

THE PERFECT START

This wonderful one bedroom starter home is found in a quiet corner of Yeading, and offers great access to local shops and transport links. Presented in good condition, this property would be ideal for a couple, or anybody wanting to have their own space with their first home. Offering a fitted kitchen, reception room to the ground floor, with the first floor presenting a double bedroom with storage and bathroom. To the outside of this house, you will benefit from a private garden and off-street parking.

Ref: KARS000612

Features

- House
- One Bedroom
- Reception Room
- Fitted Kitchen
- Bathroom
- Private Garden
- Parking
- No Onward Chain



Ground Floor

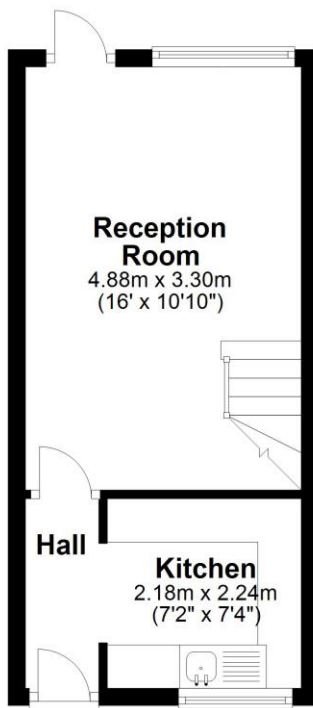

First Floor

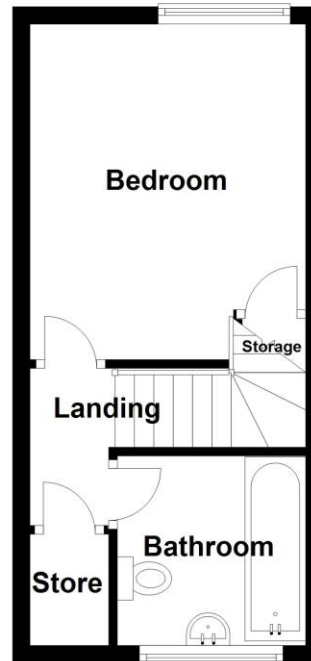

Whilst every attempt has been made to ensure the accuracy of the floor plan contained here, measurements of doors, windows, rooms and other items are approximate and no responsibility is taken for any error, omission, or mis-statement. This plan is for illustrative purposes only and should be used as such by any prospective purchaser. The services, systems and appliances shown have not been tested and no guarantee as to their operability or efficiency can be given.

Plan produced using PlanUp.

Energy Efficiency Rating		Current	Potential
Very energy efficient - lower running costs			
(92-100) A			
(81-91) B			
(69-80) C			
(55-68) D			
(39-54) E			
(21-38) F			
(1-20) G			
Not energy efficient - higher running costs			
		72	90
England & Wales	EU Directive 2002/91/EC		

Environmental Impact (CO ₂) Rating		Current	Potential
Very environmentally friendly - lower CO ₂ emissions			
(92-100) A			
(81-91) B			
(69-80) C			
(55-68) D			
(39-54) E			
(21-38) F			
(1-20) G			
Not environmentally friendly - higher CO ₂ emissions			
England & Wales	EU Directive 2002/91/EC		

Location

