



Fairey Avenue, Hayes

£339,950 Leasehold

COMMUTERS PARADISE

Karwood offer to the market this two bedroom ground floor maisonette, benefiting from having its own private rear garden and being minutes away from the Hayes and Harlington main line Train Station. This location offers an array of local amenities, including shops, schools, transport links, supermarkets and the town centre is only a short walk away. So, if you are on the hunt for your new home and are looking for something that is ready to move into you may find that this property ticks the boxes.

Ref: KPL1000288

Features

- Maisonette
- Ground Floor
- Two Bedrooms
- New bathroom
- New Fitted kitchen
- Private garden
- No Chain
- Close to Station



Ground Floor

Approx. 49.2 sq. metres (529.4 sq. feet)

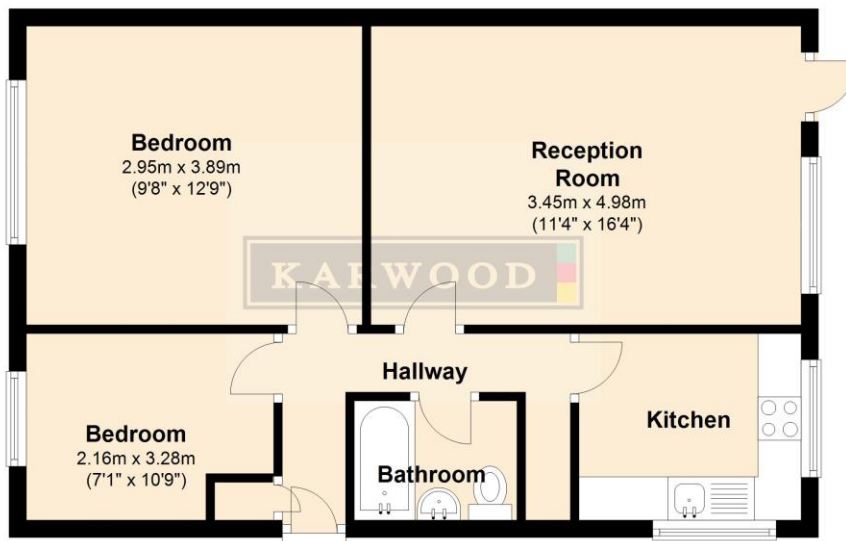

Total area: approx. 49.2 sq. metres (529.4 sq. feet)

Whilst every attempt has been made to ensure the accuracy of the floor plan contained here, measurements of doors, windows, rooms and other items are approximate and no responsibility is taken for any error, omission, or mis-statement. This plan is for illustrative purposes only and should be used as such by any prospective purchaser. The services, systems and appliances shown have not been tested and no guarantee as to their operability or efficiency can be given.

Plan produced using PlanUp.

Energy Efficiency Rating		Current	Potential
Very energy efficient - lower running costs			
(92-100)	A		
(81-91)	B		
(69-80)	C		
(55-68)	D		
(39-54)	E		
(21-38)	F		
(1-20)	G		
Not energy efficient - higher running costs			
		68	77
England & Wales		EU Directive 2002/91/EC	

Environmental Impact (CO ₂) Rating		Current	Potential
Very environmentally friendly - lower CO ₂ emissions			
(92-100)	A		
(81-91)	B		
(69-80)	C		
(55-68)	D		
(39-54)	E		
(21-38)	F		
(1-20)	G		
Not environmentally friendly - higher CO ₂ emissions			
		69	80
England & Wales		EU Directive 2002/91/EC	

