



Hayes

£429,950 Freehold

Delightfully Detached

Karwood present to the market this well presented two double bedroom detached Bungalow found close to transport links and local amenities. Relax and enjoy the peace and calm that comes along with a property that is ready to move in to without having to worry about getting your overalls on or calling in the builders. You will love the style and feel of this home as it has been decorated in a neutral design that is sure to meet most people's tastes.

Ref: KPL1000283

Features

- Detached
- Bungalow
- Two Bedroom
- Reception Room
- Kitchen
- Shower room
- Own drive To Garage
- Off Street Parking



Ground Floor

Approx. 63.6 sq. metres (684.8 sq. feet)

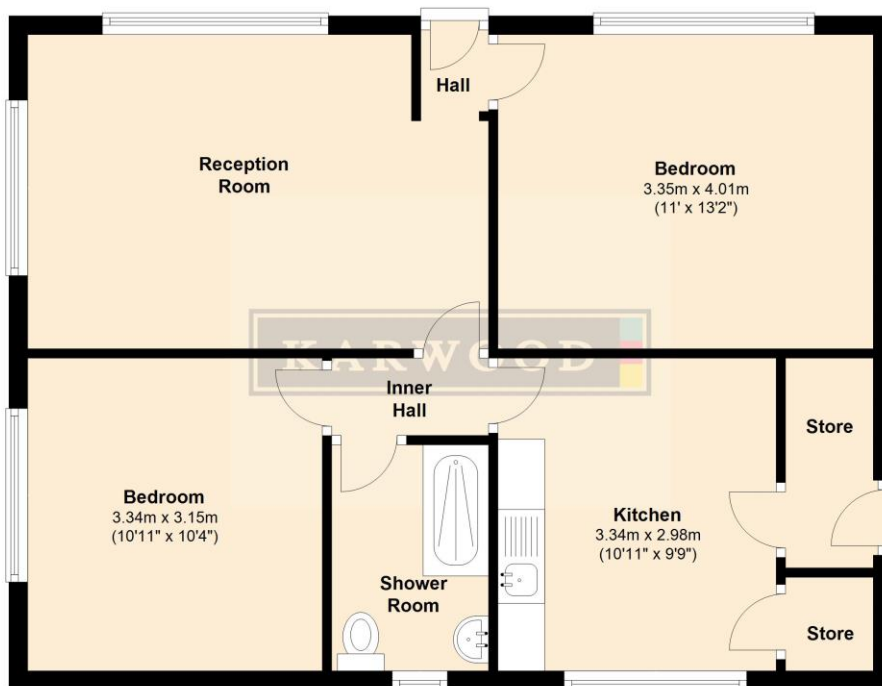

Total area: approx. 63.6 sq. metres (684.8 sq. feet)

Whilst every attempt has been made to ensure the accuracy of the floor plan contained here, measurements of doors, windows, rooms and other items are approximate and no responsibility is taken for any error, omission, or mis-statement. This plan is for illustrative purposes only and should be used as such by any prospective purchaser. The services, systems and appliances shown have not been tested and no guarantee as to their operability or efficiency can be given.

Plan produced using PlanUp.

Energy Efficiency Rating		
	Current	Potential
Very energy efficient - lower running costs		
(92-100) A		
(81-91) B		
(69-80) C		
(55-68) D		
(39-54) E		
(21-38) F		
(1-20) G		
Not energy efficient - higher running costs		
England & Wales		
	EU Directive 2002/91/EC	

Environmental Impact (CO ₂) Rating		
	Current	Potential
Very environmentally friendly - lower CO ₂ emissions		
(92-100) A		
(81-91) B		
(69-80) C		
(55-68) D		
(39-54) E		
(21-38) F		
(1-20) G		
Not environmentally friendly - higher CO ₂ emissions		
England & Wales		
	EU Directive 2002/91/EC	

Location

