



SOUTH HAYES

£419,950 Freehold

JUST THE TICKET

Karwood bring to the market this three bedroom semi-Detached house in South Hayes. Offering any new owner the ideal location from great access to the M4/M25, Heathrow Airport or a walk down to Hayes and Harlington Main line train station. The property presents the perfect chance for a new family to add their own flare and style and the possibility of an extension (STPP). Parking is also catered for via the off street to the front or the garage which is accessed via shared drive. Given the location and the size we expect demand to be high, so give us a call and find out more.

Ref: KPL1000219

Features

- Semi-Detached
- Three Bedrooms
- Reception Room
- Diner
- Kitchen
- First Floor Shower Room
- Off Street Parking
- South Hayes



Ground Floor

Approx. 39.5 sq. metres (425.1 sq. feet)

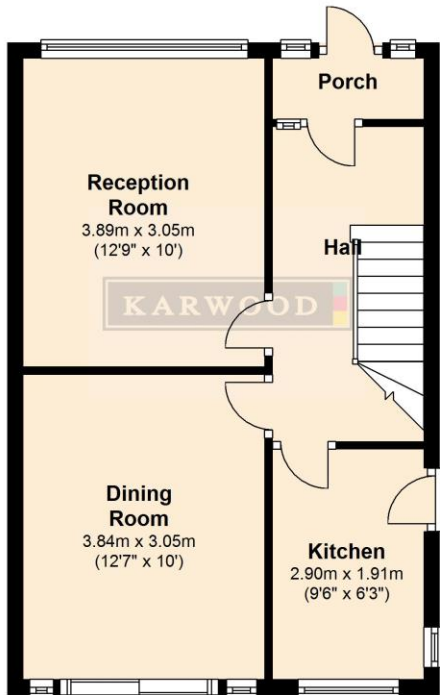

First Floor

Approx. 39.3 sq. metres (423.2 sq. feet)

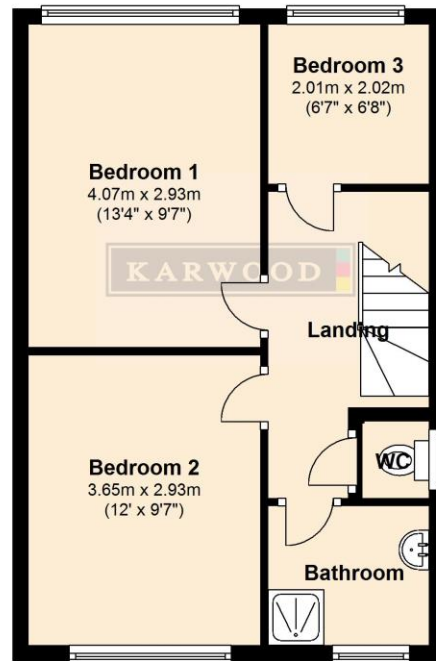

Total area: approx. 78.8 sq. metres (848.3 sq. feet)

Whilst every attempt has been made to ensure the accuracy of the floor plan contained here, measurements of doors, windows, rooms and other items are approximate and no responsibility is taken for any error, omission, or mis-statement. This plan is for illustrative purposes only and should be used as such by any prospective purchaser. The services, systems and appliances shown have not been tested and no guarantee as to their operability or efficiency can be given.

Plan produced using PlanUp.

Location

