



HAYES

£429,950 Freehold

PERFECT CONDITION

Karwood are pleased to bring to the market this stunning three/four bedroom house located in the heart of Hayes. All that you would need is located a short walk away from local shops, bus routes to Uxbridge and a host of restaurants and coffee shops. If getting in to central London is important then you will be pleased to hear that Hayes and Harlington main line station is to be found less than a mile away and with Cross rail on its way to Hayes getting in to town is going to be a lot quicker. Having spent many years making this their perfect home it could be you that benefits from all the current owners hard work.

Features

- Mid Terrace Property
- Three/ Four Bedrooms
- Fitted kitchen/Diner
- Ground Floor W.C
- First Floor Shower Room
- Reception Room
- Off Street Parking
- Great Condition



Ground Floor

Approx. 49.0 sq. metres (527.3 sq. feet)

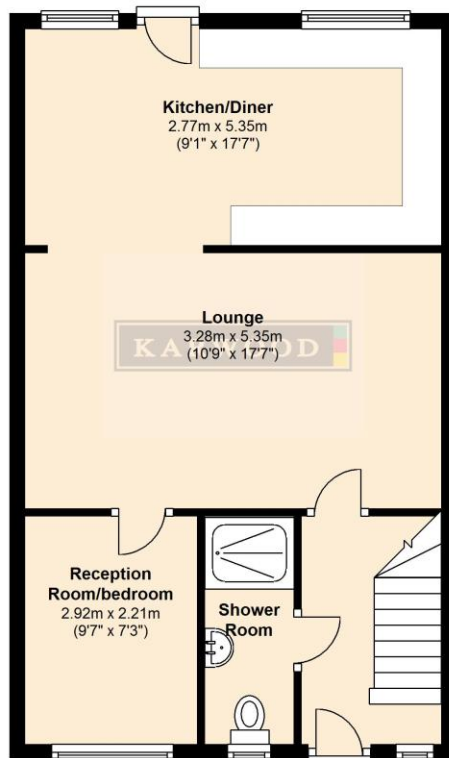

First Floor

Approx. 33.9 sq. metres (365.3 sq. feet)

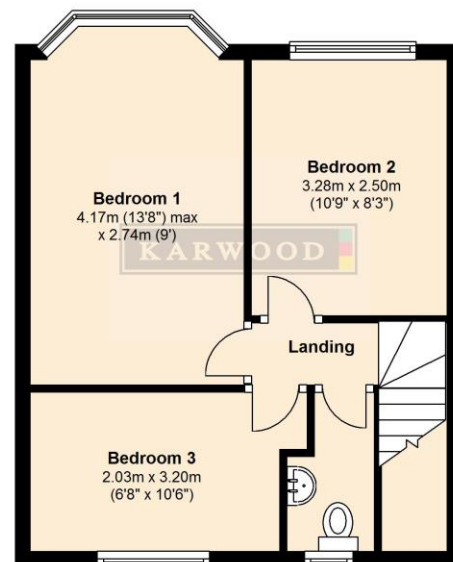

Total area: approx. 82.9 sq. metres (892.6 sq. feet)

Whilst every attempt has been made to ensure the accuracy of the floor plan contained here, measurements of doors, windows, rooms and other items are approximate and no responsibility is taken for any error, omission, or mis-statement. This plan is for illustrative purposes only and should be used as such by any prospective purchaser. The services, systems and appliances shown have not been tested and no guarantee as to their operability or efficiency can be given.

Plan produced using PlanUp.

Location

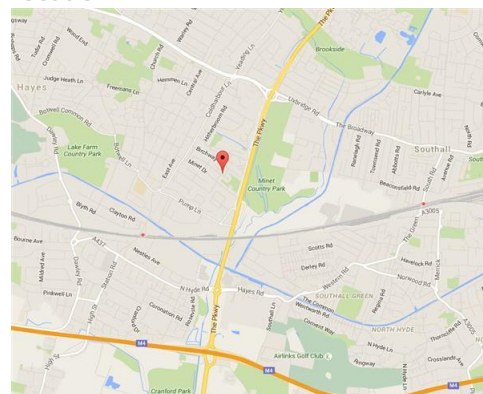

Energy Efficiency Rating	
Current	Potential
A (92-100)	A (92-100)
B (81-91)	B (81-91)
C (69-80)	C (69-80)
D (55-68)	D (55-68)
E (39-54)	E (39-54)
F (21-38)	F (21-38)
G (1-20)	G (1-20)
70	85

Environmental Impact (CO ₂) Rating	
Current	Potential
A (92-100)	A (92-100)
B (81-91)	B (81-91)
C (69-80)	C (69-80)
D (55-68)	D (55-68)
E (39-54)	E (39-54)
F (21-38)	F (21-38)
G (1-20)	G (1-20)
69	85